

MAHLE

Industry

Bag Filter Housings Nowata W Series Multi-Round

Customization of Most Features is Available

Request a Quote Today!

1. Introduction

The Multi-Round, W series, bag housings effectively remove dirt, pipe scale, and other contaminants from process liquids such as water, chemical and petroleum products. They can be used with standard #2 size bags or the included perforated baskets as strainers. Housing material is available in carbon steel or 316 stainless steel wetted construction.

Optional construction design can include exotic materials (such as Hastelloy), different connection styles and sizes, bag hold down plate or baskets with mesh lining.

Housings that are 24 inches and under, outside diameter, feature a flat top style lid, while housings over 24 inches O.D. utilize a dish style lid (as shown).

Features such as inlet & outlet locations can be customized from side-in/side-out, to bottom-in/bottom-out, or same side in & out.

Features

- Standard housings are ASME code design, optional "U" stamp also available
- Standard - All wetted parts 316 stainless steel or carbon steel, other materials are available
- 150 psi working pressure
- Heavy duty support legs
- Housings hold standard #2 size bags (7" x 30") using 316 stainless steel internal baskets
- Designed for use with heavy duty, high efficiency bags and standard thickness conventional bags
- Swing bolt closure with Buna o-ring seal and head lifting davit
- Custom configurations available upon request



2. Dimensional Information

A Model O.D.	B I/O Size	C	D	E	F	G	Leg Bolts 7/8" Holes	Weight (approx. lbs.)	Number of Baskets	Total Filtration Surface Area (approx.)
18"	2	46	56	35	19	29	4 places on 16" Bolt Center	360	3	9.9 sq.ft.
	3							385		
	4							400		
20"	2	41.69	56.13	38	18.38	34	4 places on 18" Bolt Center	410	3	13.2 sq.ft.
	3			37.88						
	4			37.13						
22"	3	47.31	57.75	37	21	35	4 places on 20" Bolt Center	500	4	17.6 sq.ft.
	4							515		
	6							560		
24"	3	49.38	59.56	41	21	36	8 places on 28" Bolt Center	535	6	26.4 sq.ft.
	4			40						
	6			39.13						
30"	4	43.38	57.5	33	22	44	8 places on 34" Bolt Center	665	8	35.2 sq.ft.
	6			33						
	8			32						
36"	6	46.63	60.25	35	26	52	8 places on 40" Bolt Center	870	12	52.8 sq.ft.
	8			34.5						
	10			33						
42"	8	50.75	64.75	37.5	27.5	58	8 places on 46" Bolt Center	1960	17	74.8 sq.ft.
	10			36						
	12			35						
48"	8	51.25	66.13	36	29	64	8 places on 52" Bolt Center	2200	23	101.2 sq.ft.
	10			34.5						
	12			33.5						

Dimensions shown in inches unless otherwise noted. Dimensions are approximate values and not intended for piping specifications.

Due to our continuing program of product improvement, specifications are for reference only and subject to change without notice.

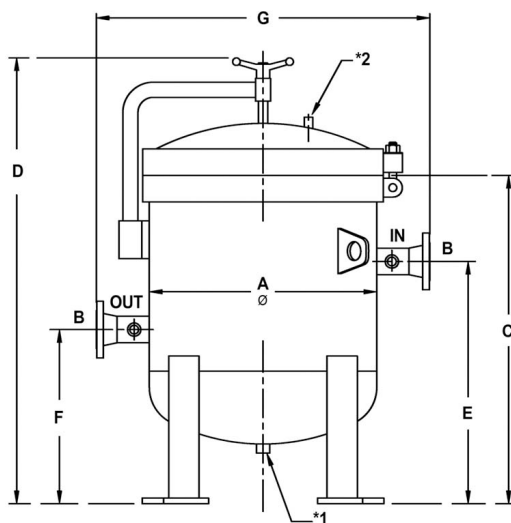

NOTES:

Unfiltered fluid enters the housing inlet and into the open area under the dome of the cover. Flow is distributed uniformly through the bags or baskets, from inside to outside. Solids are collected on the inside of the bags or baskets, where they can be removed easily and completely.

Housing with 316 stainless steel wetted construction have carbon steel external bolting, legs, davit arm and davit handle. Standard o-ring material is Buna. DP taps are located on the inlet and outlet piping and allow monitoring of bags or baskets during operation.

*1 = Drain 1 inch

*2 = Vent FNPT 1/2 inch



Authorized MAHLE-Nowata Distributor & Representative

For pricing and information please call
Commercial Filtration Supply at (855)-236-0467

Visit us Online at: www.commercialfiltrationsupply.com
for more filtration products.