

MAHLE

Industry

Cartridge Filter Housings Nowata N Series High Flow

Wide Range of Features and Options
Aqueous Flow Rates to 4600 gpm

Request a Quote Today!

1. Introduction

The N series high-flow, multi-cartridge filter housings are designed for long life and exceptional value. These multipurpose, high flow, 150 psi filters are built with our continued commitment to quality that has made us a leader in filtration systems worldwide.

N series filter housings have numerous, customizable options and features including sizes ranging from 22 to 230 cartridge models. Housing construction materials are carbon steel (NC series) or 316 stainless steel (NU series). All N series filters are built to ASME code design standards for added quality assurance.

Features

- 150 psi working pressure
- Aqueous flow rates up to 4600 gpm
- 1/32" Corrosion allowance standard for carbon steel, 0" Allowance for 316 stainless steel
- All models built to ASME code standards, code stamp available upon request
- 7 Housing size options: 22, 36, 55, 88, 128, 174 and 230 cartridge models
- Construction materials: carbon steel (NC series), or 316 stainless steel (NU series)
- 150# Flanged inlet and outlet connections are available
- 2" FNPT internal pipe thread inlet chamber dirty drain, 1" FNPT clean drain, & 1/2" FNPT vent are standard
- 3 Cartridge length options: 29-1/4", 30" or 40"
- Accepts 2-1/2" outside diameter by 1" inside diameter filter cartridges
- 316 Stainless cup and spring cartridge mounting hardware. Cup design accepts double open-end or 222 o-ring style cartridges without modification
- Swing bolt closure for fast and easy cartridge replacement
- Buna o-ring closure seal is standard, other seal materials are available



2. Dimensional Information

Model Number	Material	No. Round x No. High	No. of Cartridges	Cartridge Length	Connection Size and Type	A	B	C	D
NC66TU15W4	Carbon steel	22 x 3	66	29-1/4 or 30	4" 150#	16	64	38	17
NU66TU15W4	316 SS	22 x 3	66	29-1/4 or 30	4" 150#	16	64	38	17
NC88QU15W4	Carbon steel	22 x 4	88	40	4" 150#	16	74	38	17
NU88QU15W4	316 SS	22 x 4	88	40	4" 150#	16	74	38	17
NC108TU15W6	Carbon steel	36 X 3	108	29-1/4 or 30	6" 150#	20	68	40	18.5
NU108TU15W4	316 SS	36 X 3	108	29-1/4 or 30	6" 150#	20	68	40	18.5
NC144QU15W6	Carbon steel	36 X 4	144	40	6" 150#	20	78	40	18.5
NU144QU15W6	316 SS	36 X 4	144	40	6" 150#	20	78	40	18.5
NC165TU15W6	Carbon steel	55 x 3	165	29-1/4 or 30	6" 150#	24	81	44	23
NU165TU15W6	316 SS	55 x 3	165	29-1/4 or 30	6" 150#	24	81	44	23
NC220QU15W6	Carbon steel	55 x 4	220	40	6" 150#	24	85	44	23
NU220QU15W6	316 SS	55 x 4	220	40	6" 150#	24	85	44	23
NC264TU15W8	Carbon steel	88 X 3	264	29-1/4 or 30	8" 150#	30	85	48	25.5
NU264TU15W8	316 SS	88 X 3	264	29-1/4 or 30	8" 150#	30	85	48	25.5
NC352QU15W8	Carbon steel	88 X 4	352	40	8" 150#	30	91	48	25.5
NU352QU15W8	316 SS	88 X 4	352	40	8" 150#	30	91	48	25.5
NC384TU15W10	Carbon steel	128 x 3	384	29-1/4 or 30	10" 150#	36	90	52	27
NU384TU15W10	316 SS	128 x 3	384	29-1/4 or 30	10" 150#	36	90	52	27
NC512QU15W10	Carbon steel	128 x 4	512	40	10" 150#	36	100	52	27
NU512QU15W10	316 SS	128 x 4	512	40	10" 150#	36	100	52	27
NC522TU15W12	Carbon steel	174 x 3	522	29-1/4 or 30	12" 150#	42	96	56	30
NU522TU15W12	316 SS	174 x 3	522	29-1/4 or 30	12" 150#	42	96	56	30
NC696QU15W12	Carbon steel	174 x 4	696	40	12" 150#	42	102	56	30
NU696QU15W12	316 SS	174 x 4	696	40	12" 150#	42	102	56	30
NC690TU15W14	Carbon steel	230 x 3	690	29-1/4 or 30	14" 150#	48	102	60	33
NU690TU15W14	316 SS	230 x 3	690	29-1/4 or 30	14" 150#	48	102	60	33
NC920QU15W14	Carbon steel	230 x 4	920	40	14" 150#	48	108	60	33
NU920QU15W14	316 SS	230 x 4	920	40	14" 150#	48	108	60	33

Dimensions shown in inches unless otherwise noted. Due to our continuing program of product improvement, specifications are for reference only and subject to change without notice. Dimensions are approximate values and not intended for piping specifications.

NOTES:

- *1 = Vent connection: 1/2" FNPT
- *2 = Dirty drain connection: 2" FNPT
- *3 = Clean drain connection: 1" FNPT
- NU series filters have all wetted surfaces made of 316 stainless steel
- Legs and swing bolts made of carbon steel
- Housings with a 24 inch O.D. or less will have a flat top closure
- Larger O.D. housings will have a dish top closure (as shown)

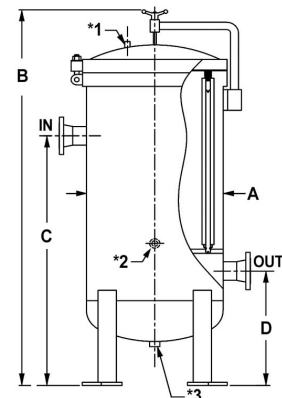

Authorized MAHLE-Nowata Distributor & Representative

For pricing and information please call
Commercial Filtration Supply at (855)-236-0467

Visit us Online at: www.commercialfiltrationsupply.com

for more filtration products.